

Codecasa 34



Asking price: €3,450,000 (VAT Paid)

BUILDER:	Codecasa, Italy	LOA:	33.50m
YEAR:	1999 (Refit in 2007)	BEAM:	7.20m
FLAG:	British	DRAFT:	2.20m
DESIGNER:	Codecasa S.p.A	SPEED:	14 -15.5 Knots
ACCOM:	9 guests in 4 staterooms	HULL:	Steel
LYING:	Viareggio, Italy	ENGINES:	2 x 1050hp CAT 3412C

Exterior Images









Interior Images













Layout

WELLHOUSE AND SUN DECK

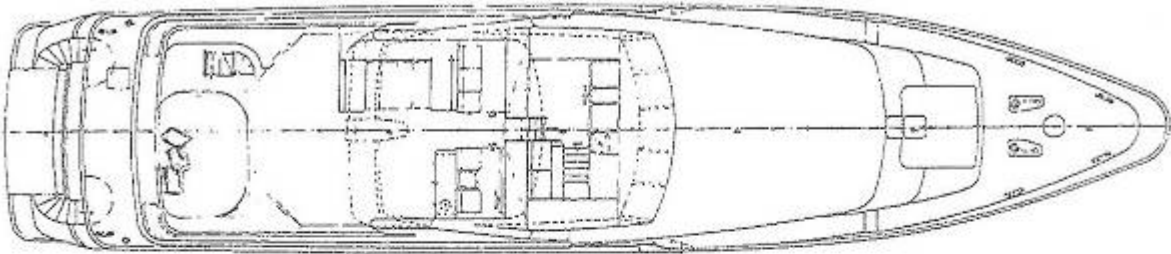

MAIN DECK

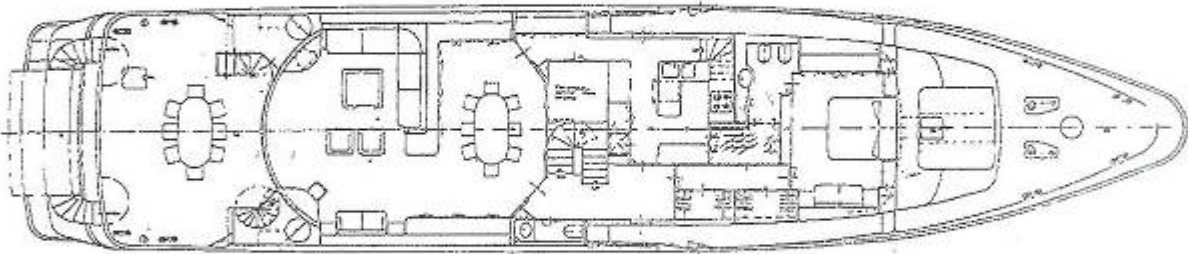

LOWER DECK

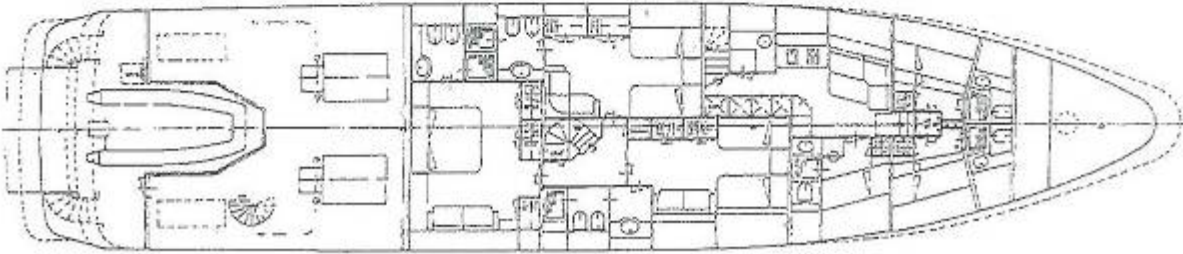

The Specification

The yacht's general design work came from Codecasa. The technical naval architecture plans are the creation of Codecasa Yacht Design and she received her stylish look from the interior design skills of Studio Dellarole. In 2007 had a further refitting and updating.

Gross Tonnes:	231
Net Tonnes: Displacement:	160
Hull / Superstructure:	Steel / Aluminium
Material Used For Deck:	Teak
Flag:	British
The official registry port:	London
Yacht Beam:	7.19m/23.6ft
Waterline Length (LWL):	27.52m/90.3ft
Draught Maximum:	2.23m/7.3ft
Classification:	Lloyd's 100 A1 SSC, Yacht, Mono, G6 LMC

Technical details

Machinery

Engines:	2 x Caterpillar 3412C (1050hp)
Engine hours:	Port: 3500 Stbd: 3500 (August 2015)
Generators:	2 x 50kW Kohler
Generator hours:	Port: 11000 Stbd: 11000 (August 2015)

Auxiliary Equipment

Gearbox:	ZF
Fuel separator:	Alfa Laval
Watermaker:	2 x Technicomar 300 litres per hour
Air conditioning:	Francesconi 3 Compressor
Bow thruster:	EAS 50kw hydraulic
Stabilizers:	Vosper underway fins
Sewage treatment:	Hamann

Tankage

Fuel:	50,000 litres
Fresh water:	4300 litres
Black water:	1400 litres
Grey water:	300 litres

Performance

Maximum speed: 15.5 kts
Cruising speed: 14 kts @ 2000RPM
Range (approx): 3750 NM – 12kts @1800 RPM
Consumption: 160 litres per hour @ 12 knots

Navigation & Communication Equipment

Furuno Gyro compass
Fuselli Compass,
Plath Autopilot
2 x Furuno ARPA radar
SAILOR INMARSAT C
Seatel SATCOM
Furuno – 2 x GPS
Furuno Depthsounder
Phone System throughout vessel
SAILOR DSC VHF
GARMIN VHF
MAXSEA Chart Plotter
Autronica fire system

Deck Equipment

2 x anchors with 160m chain, stbd and 130m chain, port
2 x windlass
2 x aft warping capstans
Sanguinetti retractable passarelle
Aft deck furniture – table and 8 chairs

Sun Deck

Ice maker
Drinks fridge in bar area
BBQ
Built-in seating and table for 10 guests
Large sunbathing area

Galley

Samsung American double door Fridge-Freezer
Gaggenhau Oven
Gaggenhau 4 ring hob
Gaggenhau steamer
Giorik Grill
1 x Bosch Dishwashing machine
1 x custom built freezer
2 x custom built fridges

Laundry

Miele Clothes washing machine
Miele Clothes drying machine

Crew Mess

AEG Dish washing machine
Miele 2 ring hob
Miele extractor hood
Liebherer fridge
Security screen
Sony HIFI
LG television

Interior

Main Saloon

Full width lounge area for 8-10 guests
Dining table for 10 guests
60" SHARP Flat Screen
BOSE DVD player
Denon Surround Sound Receiver
GLA Satellite Receiver
Sony Hi-fi components
Sky satellite receiver
60" SHARP Flat Screen
BOSE DVD player
Denon Surround Sound Receiver
GLA Satellite Receiver
Sony Hi-fi components
Sky satellite receiver

Accommodations

Owner's Suite
1 Double Bed Cabin
2 Twin Bed Cabins
5 Guest Bathrooms
1 Captain's Cabin; 2 Twin Bed Crew Cabin; 3 Crew Bathrooms
13 Passengers Cruising
9 Sleeping + 5 Crew

Main deck Owner's Stateroom

King size bed
Sofa
Frigomar drinks fridge
50" SHARP Flat Screen TV
Sony HI FI
Sky satellite receiver
2 x walk in wardrobes
Bathroom 1 – shower; bidet, toilet, large vanity unit
Bathroom 2 – spa shower; toilet, vanity unit

Lower Deck Cabins

VIP Cabin

King sized bed

Sofa

40" SHARP Flat Screen TV

2 x double built in wardrobes

Bathroom – shower, toilet, bidet, large vanity unit

Port Cabin

2 x single beds

Large wardrobe

Desk

Sofa

32" SHARP Flat Screen TV

Bathroom with shower, toilet, bidet and vanity unit

Starboard Cabin

2 x single beds and 1 x Pullman

Large wardrobe

Desk

40" SHARP Flat Screen TV

Bathroom with separate access from lower deck foyer for use as day head; vanity unit, shower, bidet and toilet

Crew Accommodation

5 crew in 2 x twin bunk cabins and 1 x single berth cabin

Tenders and Toys

Tender – 26' JOKER RIB with Yamaha 250hp
4m Zodiac with Suzuki 9.9hp

Safety and Fire Protection

2 x Liferafts

E.P.I.R.B

SART Pathfinder